

## In the Box

---

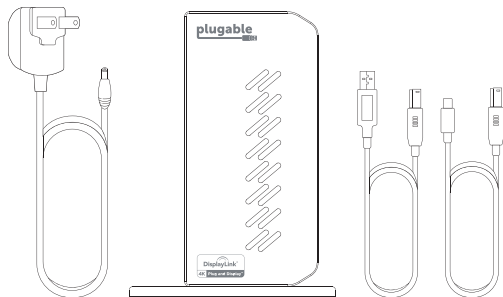

### Questions? We're here to help!

[plugable.com/products/ud-6950z](https://plugable.com/products/ud-6950z)

[support@plugable.com](mailto:support@plugable.com)

ご質問は下記へご連絡ください。 [nihongo@plugable.com](mailto:nihongo@plugable.com)

[plugable.com/ja/products/ud-6950z](https://plugable.com/ja/products/ud-6950z)

© 2020 Plugable Technologies | April 20<sup>th</sup>, 2020



## UD-6950Z DOCKING STATION

### Quick Start Guide

Guía de inicio rápido | Guide de démarrage rapide |  
Guida introduttiva | Kurzanleitung | クイック・スタート・ガイド

## Thank you for your purchase of the Plugable UD-6950Z Docking Station!

---

The Plugable UD-6950Z Docking Station connects to a supported system using an included USB cable and provides the ability to connect up to two additional 4K HDMI or DisplayPort displays, six additional USB 3.0 ports, a wired Gigabit Ethernet port, and 3.5mm combination analog audio input/output jack.

## 1. Download and install driver.

Descargar e instalar el controlador.  
Télécharger et installer le pilote.  
Scarica e installa il driver.  
Treiber herunterladen und installieren.  
ドライバをダウンロードし、インストールします。

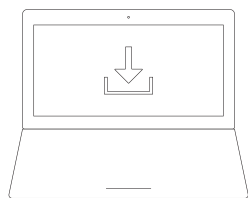

[plugable.com/products/ud-6950z](https://plugable.com/products/ud-6950z)

## 2. Connect to power.

Enchufar a la corriente.  
Brancher sur l'électricité.  
Connetti all'alimentazione.  
An ein Stromnetz anschließen.  
電源を接続します。

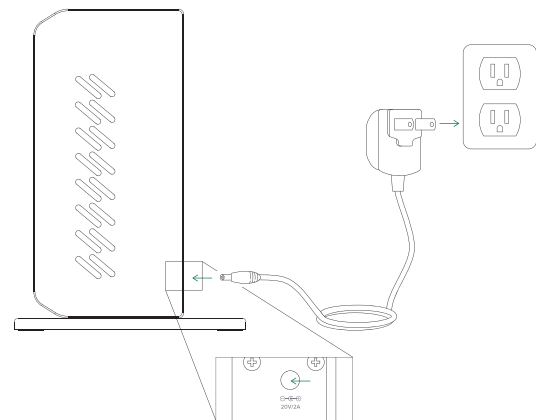

## 3. Connect the dock to host.

Conectar la base al servidor.  
Connecter le dock à l'hôte.  
Collega il dock all'host.  
Dock mit dem Host verbinden.  
ドッキングステーションをシステムに接続します。

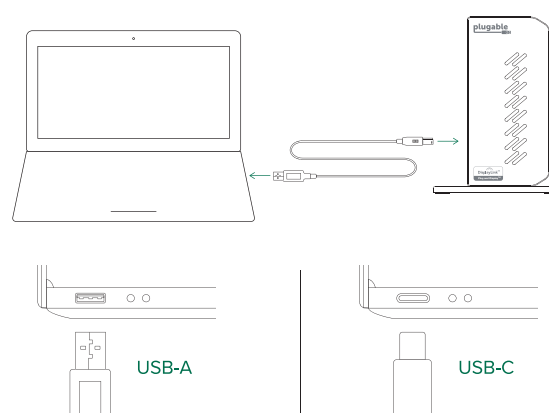

## 4. Connect peripherals.

Conectar los periféricos.  
Connecter des périphériques.  
Collega le periferiche.  
Andere Geräte anschließen.  
周辺機器を接続します。

